



FIRE SYSTEMS

TAYFUR WATER SYSTEMS

TYPHOON®

We **Care** About
Every Drop of
Water



Tayfur Water Systems, which was established by Tayfun Yazaroğlu in 2004 in Izmir. We continue our activities as "Tayfur Water Systems Machinery Engineering Industry and Trade Inc." since 2017.

Our company offers its products and experiences to the local market and international market. Tayfur Water Systems, while strengthening its recognition abroad, continues to expand its production, sales and marketing activities every day.

Our engineers and technical staff, technological infrastructure, manufacturing, sales, project-consulting, contracting and service planning meets the requirements of the sector.

Our company manufactures "TYPHOON" brand, hydraulic control valves, plastic hydraulic control valves, backwash valves, plastic backwash valves, impact-free dynamic suction cups, plastic suction cups, bottom clamps, filter reverse flushing control devices. It is progressing towards becoming a strong brand in both domestic and foreign markets by meeting the special demands of its domestic and foreign customers.

STORY OF US

Our Quality Policy

In order to be a leader in quality in the sales, marketing and service sector by complying with legal conditions and to comply with the requirements of Quality Management System in order to meet the needs and expectations of our customers, to continuously improve the efficiency and to not compromise the quality under any circumstances.

Our Mission

To be a company aiming to present its synergy in the national and international market which has always taken its responsibilities, desires and expectations of our customers in a correct, reliable and timely manner, within the framework of high quality standards, transforming efficiency and competition into an advantage...

Our Vision

To be a leading, innovative, powerful and reputable enterprise in its sector.



HYDRAULIC CONTROL VALVES

Fire Systems

Typhoon hydraulic control valves are automatic valves with direct diaphragm shut-off working with line pressure. It is a comfortable, smooth flow in the minimum pressure loss of the body and diaphragm, which is kept in the foreground in its design.

In hydraulic control valves, worn parts such as shafts, bearings and bushings are longevity. The single moving part of valves is the diaphragm.

TYPHOON hydraulic control valves, in-line drinking water pump, agricultural irrigation, fire systems, filtration, industrial, etc. designed for use in areas.

M Manually Controlled Valve

PR Pressure Reducing Control Valve

PRPS Pressure Reducing + Pressure Sustaining Control Valve

PS Pressure Sustaining Control Valve

PREL Pressure Reducing + Solenoid Controlled Valve

EL Solenoid Controlled Valve

QR Quick Relief Control Valve

FL Float Level Control Valve

FLEL Electric Float Level Control Valve

DIFL Differential Float Level Control Valve

PC Pump (Booster) Control Valve

DPC Deep Well (Submersible) Pump Control Valve

SA Surge Anticipating Control Valve

HD Hydraulic Check Valve



Working Principles

They are automatic control valves which are used hydraulically to perform the desired operations with line pressure without the need of energy sources in the mains line.

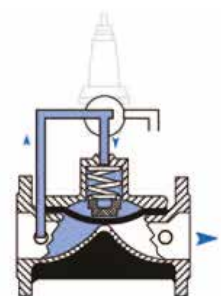

Valve Closing Mode

When the pilot discharge position on the main control valve in the closed position is reached, the pressurized water on the diaphragm of the main control valve is drained. When the line pressure reaches the position of spring force, hydraulic force is applied to the diaphragm of the control valve under water, so that the valve is in full open position.

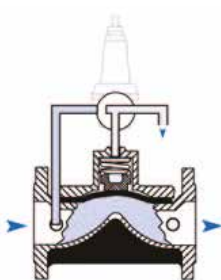

Valve Opening Mode

When the pilots on the main control valve reach the water pressure diaphragm, the water creates a hydraulic force. The resulting hydraulic force combines the diaphragm with the force applied by the spring to create a complete seal and close.

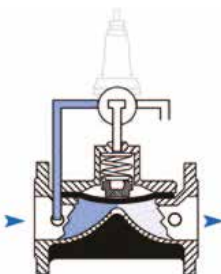



Modulation Mode

These are the pilot valves which are connected to the control valve which allows the main valve to operate in this position. According to the amount of flow and pressure to be adjusted, the water pressure on the diaphragm is controlled constantly, allowing it to operate in a modulated position.

Models

Flanged		Connection		Material		Body		Transmition Pressure			
		Flanged		GGG40		Globe		PN10 - PN16 - PN25			
		Available Diameters									
		mm	50	65	80	100	125	150	200	250	300
		inch	2	2 ^{1/2}	3	4	5	6	8	10	12

Threaded		Connection		Material		Body		Transmition Pressure		
		Threaded		GGG40		Globe		PN10 - PN16 - PN25		
		Available Diameters								
		mm	20	25	32	40	50	65	80	
		inch	3/4	1	1¼	1½	2	2½	3	

Victaulic		Connection		Material		Body		Transmition Pressure	
		Victaulic		GGG40		Globe		PN10 - PN16 - PN25	
		Available Diameters							
		mm	50	65	80	100	150	200	
		inch	2	2 ^{1/2}	3	4	6	8	

Angled		Connection		Material		Body		Transmition Pressure	
		Flanged / Threaded		GGG40		Globe		PN10 - PN16 - PN25	
		Available Diameters							
		mm	50	80	100	150			
		inch	2	3	4	6			

Sizes and Weights

Flanged	DN		D		L		H		Weight	
	inch	mm	inch	mm	inch	mm	inch	mm	Lbs	Kg
	2	50	6,50	165	8,66	220	5,87	149	17,60	8,00
	2 ^{1/2}	65	7,28	185	8,66	220	6,06	154	21,60	9,80
	3	80	7,87	200	11,26	286	6,81	173	38,80	17,46
	4	100	8,66	220	12,99	330	6,81	173	46,47	29,08
	5	125	9,84	250	14,49	368	8,35	212	62,30	28,25
	6	150	11,22	285	15,51	394	12,80	325	114,40	51,90
	8	200	13,38	340	18,19	462	14,96	380	200,80	91,10
	10	250	15,94	405	21,46	545	19,09	458	332,90	151,00
	12	300	18,11	460	22,19	582	19,69	500	392,90	178,20

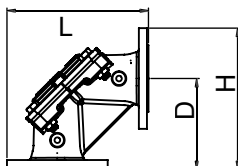
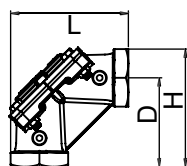

Angled	DN		D		L		H		Weight	
	inch	mm	inch	mm	inch	mm	inch	mm	Lbs	Kg
Threaded	2	50	4,4	112	6,05	154	6,05	154	9,47	4,3
	3	80	7,1	180	9,45	240	9,45	240	29,30	13,3
Flanged	2	50	4,40	112	7,44	189	7,44	189	19,07	8,65
	3	80	7,10	180	10,95	278	10,95	278	39,02	17,7
	4	100	7,48	190	12,00	305	12	305	60,19	27,3
	6	150	9,05	230	14,92	379	14,92	379	106,26	48,2

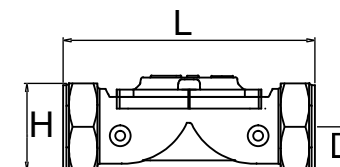
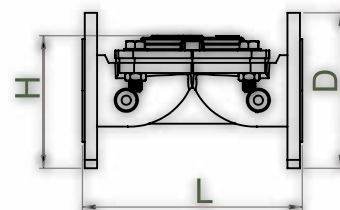

Threaded	DN		D		L		H		Weight	
	inch	mm	inch	mm	inch	mm	inch	mm	Lbs	Kg
	3/4	20	0,90	23,0	5,2	132	2,0	50,0	2,2	1,00
	1	25	0,90	23,0	5,2	132	2,0	50,0	2,2	1,00
	1 ^{1/4}	32	1,35	34,0	6,8	173	3,6	92,3	6,3	2,85
	1 ^{1/2}	40	1,35	34,0	6,8	173	3,6	92,3	5,8	2,65
	2	50	1,65	41,5	7,3	186	4,4	112,0	9,0	4,10
	2 ^{1/2}	65	1,80	46,0	8,9	226	4,6	118,0	11,7	5,30
	3	80	2,05	52,5	12,5	318	5,0	127,0	26,4	12,00

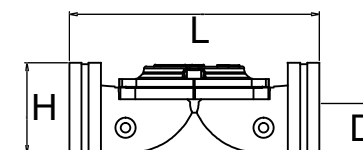

Victaulic	DN		D		L		H		Weight	
	inch	mm	inch	mm	inch	mm	inch	mm	Lbs	Kg
	2	50	1,18	30	7,24	190	3,11	79,0	8,60	3,9
	2 ^{1/2}	65	1,46	37	8,90	218	3,74	95,0	9,92	4,5
	3	80	1,77	45	11,42	290	3,70	94,0	13,00	5,9
	4	100	2,26	57,5	12,48	317	4,19	106,5	13,6	6,2
	6	150	3,30	84	17,87	392	5,24	133,0	66,00	30
	8	200	4,53	115	21,40	544	13,10	332,0	143,30	65

Main Parts

Flanged

Nr.	Material Name	Type Of Material
1	Body	GGG40
2	Diaphragm	Natural Rubber
3	Spring Seat	Polyamide
4	Spring	SST 302
5	Cover	GGG40
6	Washer	8.8 Coated Steel
7	Bolt	8.8 Coated Steel
8	Lifting Eyebolts	8.8 Coated Steel
9	Nut	8.8 Coated Steel

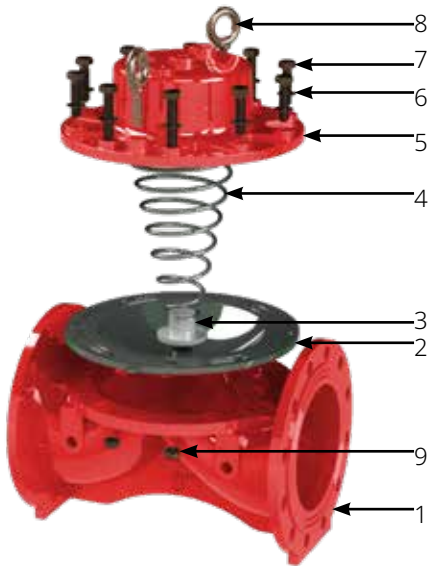

7

Threaded - Victaulic - Angled

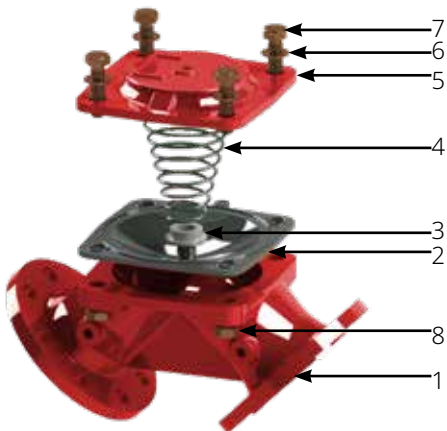
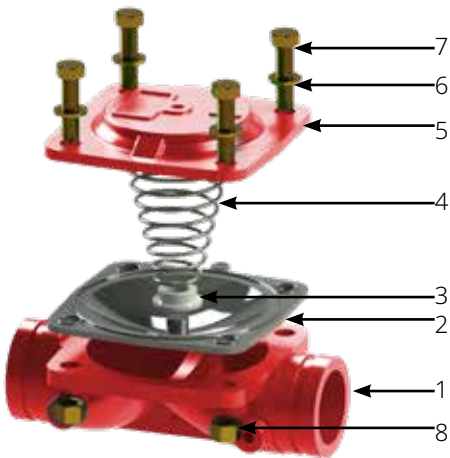
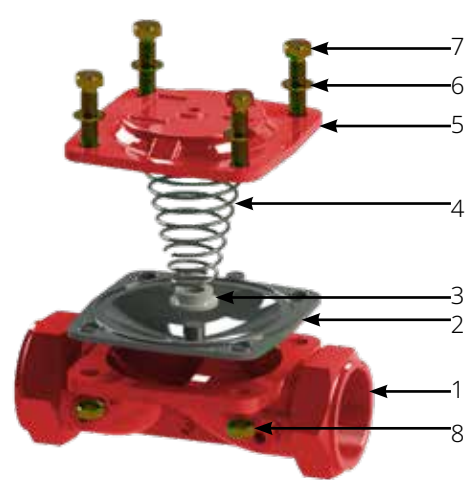

Nr.	Material Name	Type Of Material
1	Body	GGG40
2	Diaphragm	Natural Rubber
3	Spring Seat	Polyamide
4	Spring	SST 302
5	Cover	GGG40
6	Washer	8.8 Coated Steel
7	Bolt	8.8 Coated Steel
8	Nut	8.8 Coated Steel

Technical Specifications

Operating Pressure	Standard	0,7 - 16 bar (10 - 240 psi)
	Low Pressure Range	0,5 - 10 bar (7,5 - 160 psi)
	High Pressure Range	0,7 - 25 bar (10 - 360 psi)
Temperature	Minimum Operating Temp.	- 10 °C (14 °F) DIN 2401/2
	Maximum Operating Temp.	80 °C (176 °F) DIN 2401/2
Connection	Flanged	DIN 2501, ISO 7005 - 2
	Threaded	ISO (BSP) , ANSI (NPT)
Covering	Standard	Epoxy
	Optional	Polyester
Hydraulic Connections	Standard	Reinforced Nylon (Air Brake) Hydraulic Tube SAE J 844
	Optional	Copper DIN1057
Actuator Type	With Single Control Chamber Aperture With Diaphragm	

Pressure Loss Chart

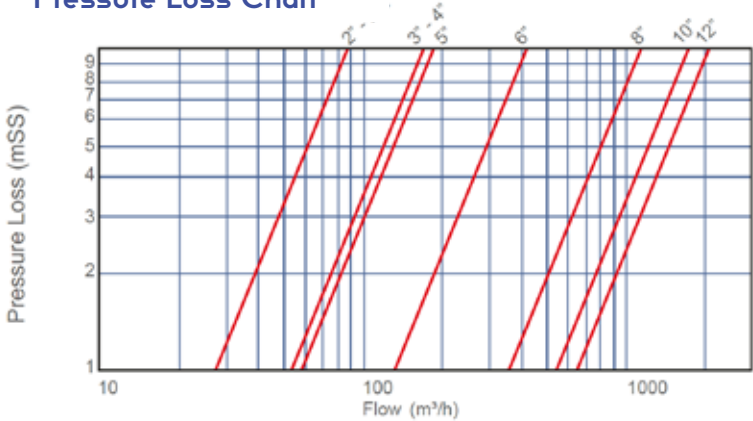

Cavitation Chart

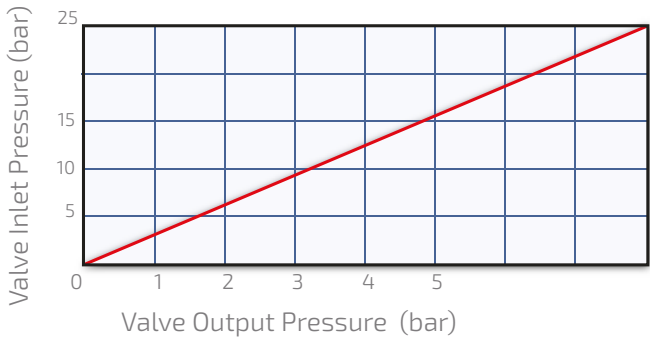

Hydraulic Performance

	inch	mm	inch	mm	inch	mm	inch	mm	inch	mm	inch	mm	inch	mm	inch	mm	inch	mm
Valve Diameter	2	50	2½	65	3	80	4	100	5	125	6	150	8	200	10	250	12	300
Kv m3/h @ 1bar	88		88		174		187		187		419		1139		1698		2276	
Cv gmp @ 1psi	102		102		201		216		216		484		1316		1961		2629	

$Kv(Cv) = Q \cdot \sqrt{G/\Delta P}$

- Kv** : Valve flow coefficient (flow rate at 1 bar pressure loss m³/h @ 1 bar)

Cv : Valve flow coefficient (flow in pressure loss of 1 psi GPM @ 1 psi)

Q : Flow (m³/h, gpm)
- Cv** = 1,155Kv

ΔP : Pressure Loss (bar, psi)

G : The specific gravity of water(Water=1.0)

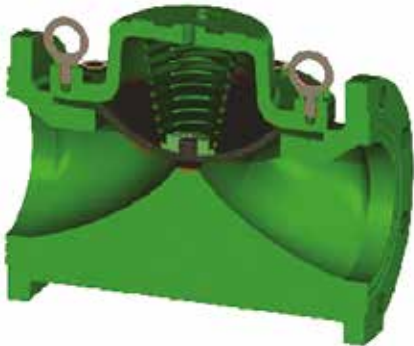

FLOAT LEVEL CONTROL VALVE

Fire Systems

The Float Level Control Valve is the hydraulic control valve designed to control water level in reservoirs and tanks continuously. Main valve is controlled by 2-way modulating type float pilot valve manually. Main valve mounted on reservoir and tank upstream is closed as fully sealed without causing surge when water level reaches to maximum level. Valve opening/closing speed may be adjusted in set value. It may be used in the system by mounting horizontal or vertical positions.

Order Information

Please provide the following information in order

Maximum flow rate m³/h
Maximum mains / operating pressure bar
Main pipeline diameter mm
Valve connection type

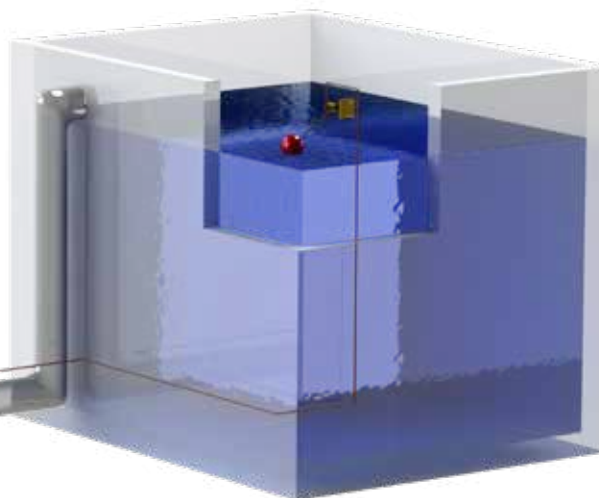

Fire Systems

Pressure Reducing Control Valves are hydraulic control valves that reduce the input pressure value to the desired pressure value by means of a pressure reducer pilot mounted on it. The pressure reducer control valve constantly controls the output pressure value to be set without being influenced by the flow rate and inlet pressure values. When there is no flow in the system, the valve closes itself. When the valve inlet pressure value in the system falls below the set outlet pressure value, the valve opens itself. The valve can be used in horizontal or vertical position on the system.

Order Information

Please provide the following information in order

Maximum flow rate m³/h
Maximum mains / operating pressure bar
Main pipeline diameter mm
Valve connection type
Maximum valve inlet pressure bar
Minimum valve inlet pressure..... bar
Desired outlet pressure value..... bar

PRESSURE REDUCING CONTROL VALVE



HYDRAULIC CHECK VALVE

Fire Systems

Hydraulic Check Valve is hydraulically controlled check valve which operates with line pressure and prevents back-flow in system. When downstream pressure value exceeds upstream pressure value, valve is closed as wholly sealed without causing surge. When upstream pressure value exceeds downstream pressure value, check valve is opened by itself slowly. So it damps pressure surges formed during start-up.

Order Information

Please provide the following information in order

Maximum flow rate m³/h
Maximum mains / operating pressure bar
Main pipeline diameter mm
Valve connection type

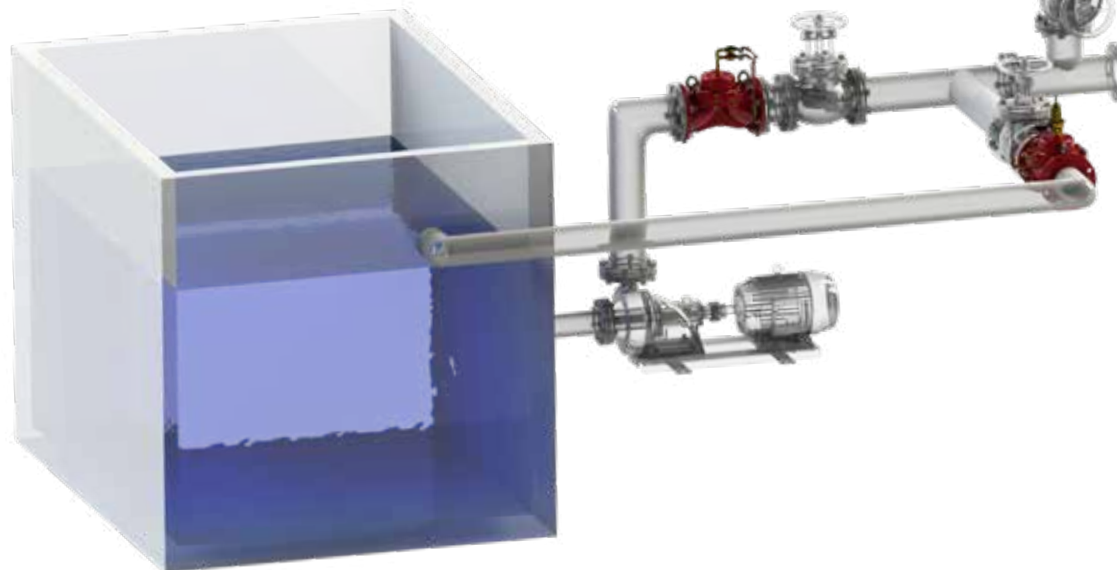

Fire Systems

The Quick Pressure Relief Control Valve is the safety control valve designed to protect system by releasing pressure surges to atmosphere quickly caused from sudden changes in water speed because pumps put into/ out of service frequently in water network elevation lines. When network pressure goes beyond set point, valve opens by itself quickly and protects system by releasing over pressure. When line pressure decreases to normal level, it is closed slowly and automatically as wholly sealed without causing surge.

Order Information

Please provide the following information in order

Maximum flow rate m³/h
Maximum mains / operating pressure bar
Main pipeline diameter mm
Valve connection type
Desired inlet pressure value..... bar

QUICK PRESSURE RELIEF CONTROL VALVE

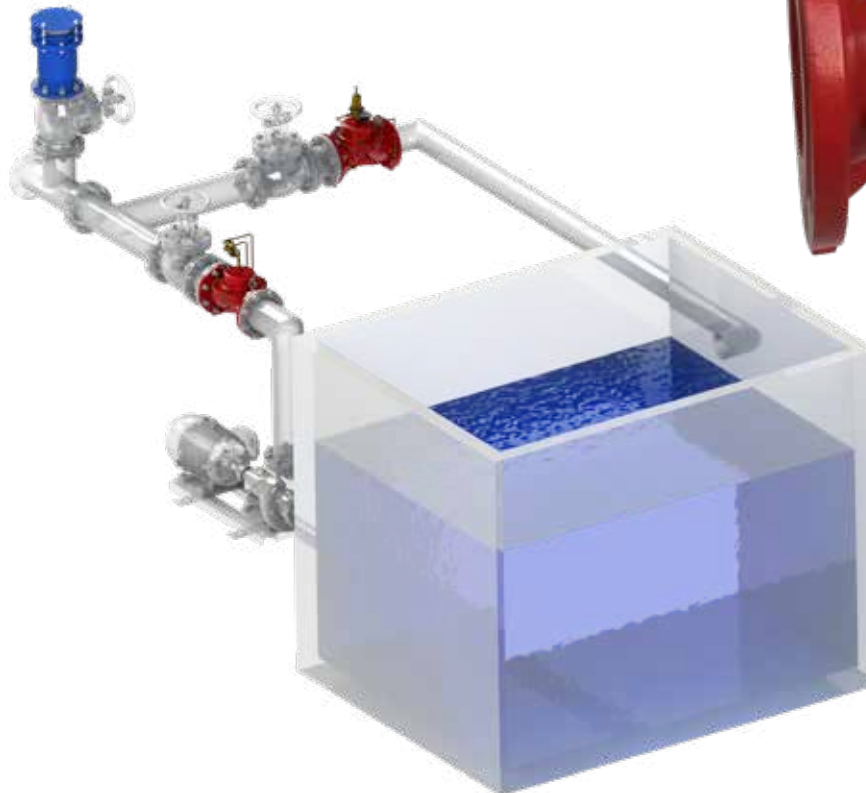

ELECTRIC FLOAT LEVEL CONTROL VALVE

Fire Systems



Electric Float Level Control Valve is a valve that constantly controls water level by electric float placed in the tank. When the water level at the bottom falls below the desired value, the electric floater sends a signal to the solenoid coil on the main valve. This allows the valve to open itself fully and keep the reservoir constantly full. When the water level reaches the maximum level, the electric switch sends a signal again to the solenoid coil and the valve closes itself. The valve can be operated on the system horizontally or vertically.

Order Information

Please provide the following information in order

Maximum flow rate m³/h
Maximum mains / operating pressure bar
Main pipeline diameter mm
Valve connection type
Electric voltage value to be used volt



Fire Systems

The Differential Float Level Control Valve is the hydraulic control valve designed to control water level in reservoirs and tanks continuously. Main valve is controlled by 2-way modulating type float pilot valve manually. Main valve mounted on reservoir and tank upstream is closed as fully sealed without causing surge when water level reaches to maximum level. Valve opening/closing speed may be adjusted in set value. It may be used in the system by mounting horizontal or vertical positions.

Order Information

Please provide the following information in order

Maximum flow rate m³/h
Maximum mains / operating pressure bar
Main pipeline diameter mm
Valve connection type
Desired level control range -m

DIFFERENTIAL FLOAT LEVEL CONTROL VALVE

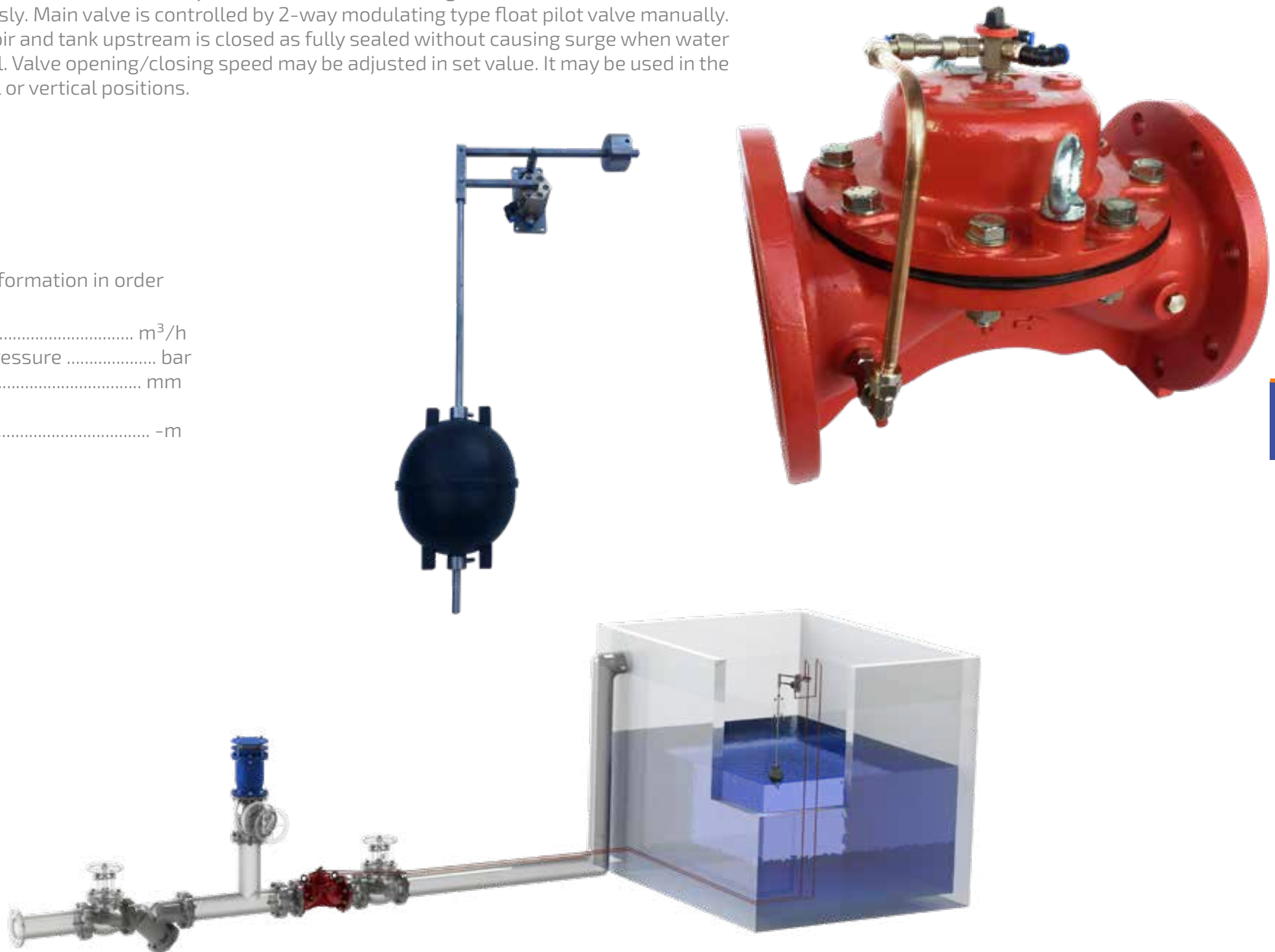

Product Brand / Ürünün Markası

TYPHOON

Directives and Regulations / Direktif ve Yönetmelikler

2014/68/EU Pressure Equipment Directive / 2014/68/EU Basınç Ekipmanları Direktifi

It has been accepted by the company that the applicable regulations for the 2014/68/EU Pressure Equipment Directive have been fulfilled and its responsibility has been taken for the products defined above. The products defined above have been checked by internal production controls carried out by the organization. If there is a change in the product, this declaration will not be accepted and will lose its validity.

Yukarıda tanımlanan verilişin önürüne karşın 2014/68/EU Basınç Ekipmanları Yönetmeliğinin uygulanabilmesi gerektirilenlerine yerine getirdiği ve bu yönetmeliğin uygulanabilmesi için gerekli şartların sağlandığını beyan etmektedir. Ürünlerin tanımlanan kuruluş tarafından yapılan iç üretim kontrol edilmiştir. Ürünlerdeki değişiklik olduğu takdirde bu beyan kabul edilemez ve geçerliliğini yitirir.

International Documenting System Doo.
Budva / Montenegro

Authorised by
Vladimir Vučić SEKULIC



It has been accepted by the country that the applicable requirements of the 2006/42/EC Machinery Safety Directive have been fulfilled and its responsibility has been taken for the products defined above. The products defined above have been checked by internal production controls carried out by the organization. If there is a change in the product, this declaration will not be accepted and will lose its validity.

Yukarıda tanımlan verilişim olan ürünlerin işi Makine Emniyeti Direktifinin uygulanabilen gerekliliklerini yerine getirdiği ve sorumluluğunu alması olduğu firma tarafından kabul edilmiştir. Yukarıda tanımlan verilişim olan ürünler, iç üretim kontrolleri sonucu kuruluş tarafından yapıldığı kontrol edilmiştir. Üründe bir değişiklik olduğu takdirde bu beyan kabul edilemeyecek ve geçerliliğini yitirecektir.

Certificate Date : 16.02.2024
Validity Date : 16.02.2025

International Documenting System Doo.
Budva / Montenegro

Authorised by
Vladimir Vučić SEKULIC



EXHIBITIONS





Kemalpaşa OSB Mahallesi Kuzey Sanayi
Caddesi Dış Kapı No:13
Kemalpaşa / İzmir

+90 232 458 49 99
+90 232 458 57 67

www.tayfursu.com.tr | info@tayfursu.com.tr

TYPHOON

**Her
Fabrika** Bir
Kaledir*

K. Atatürk

*Every factory is a fortress

